

**Public Hearing  
Zoning Commission  
September 10, 2007**

**Country  
Park PI**

**REQUESTED FROM RS-15 TO  
CD-GO-M 2.279 ACRES  
(OLD BUSINESS A)**

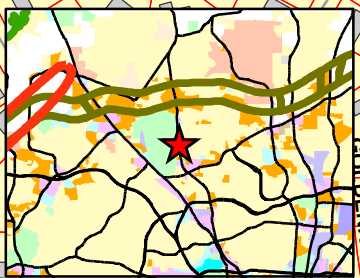

**RS-12**

**RS-15**

**RS-15**

**RS-12**

**RS-12**

**RS-15**

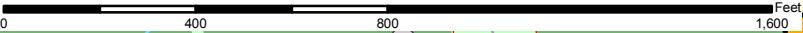
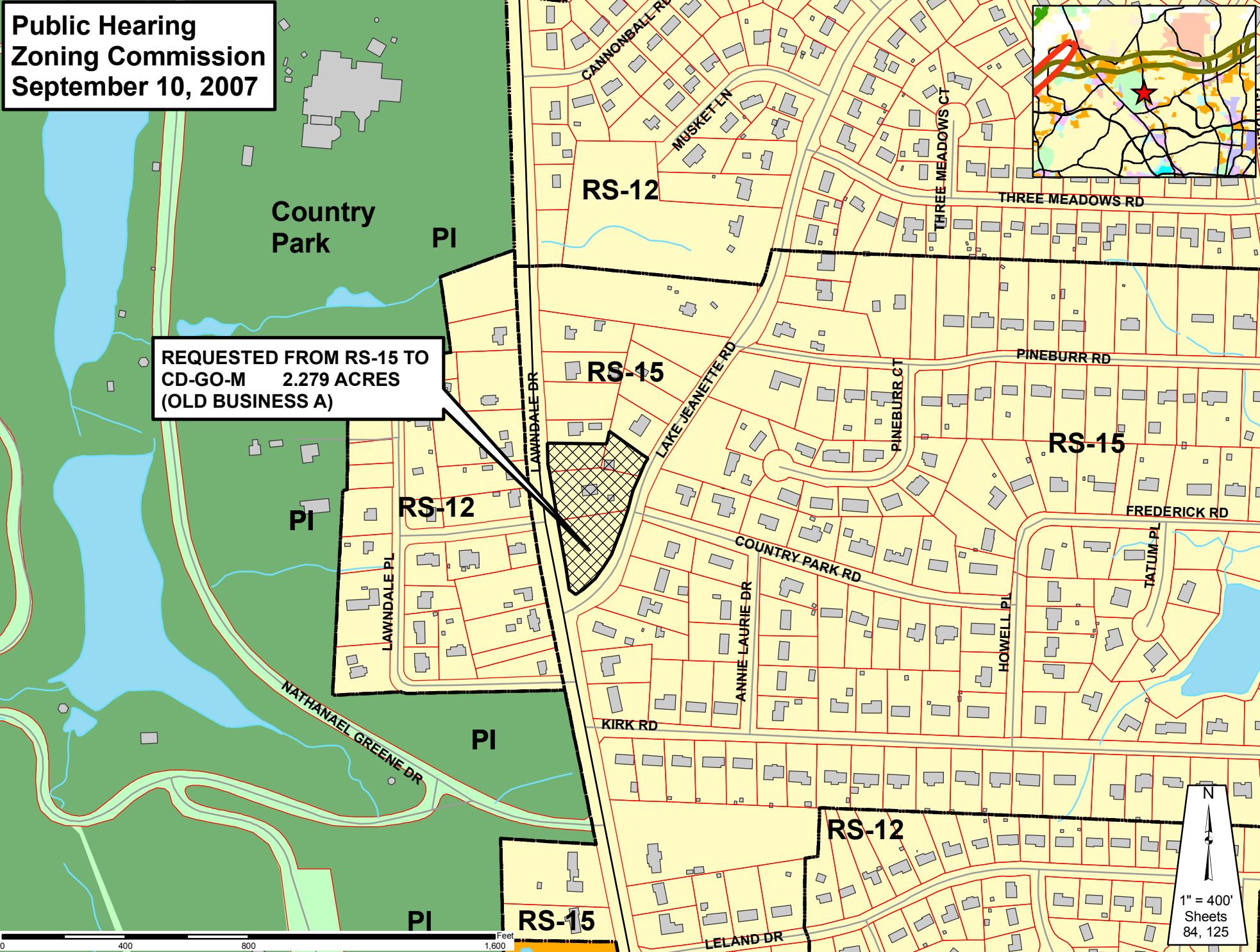

**N**  
1" = 400'  
Sheets  
84, 125