

Public Hearing Zoning Commission September 21, 2015

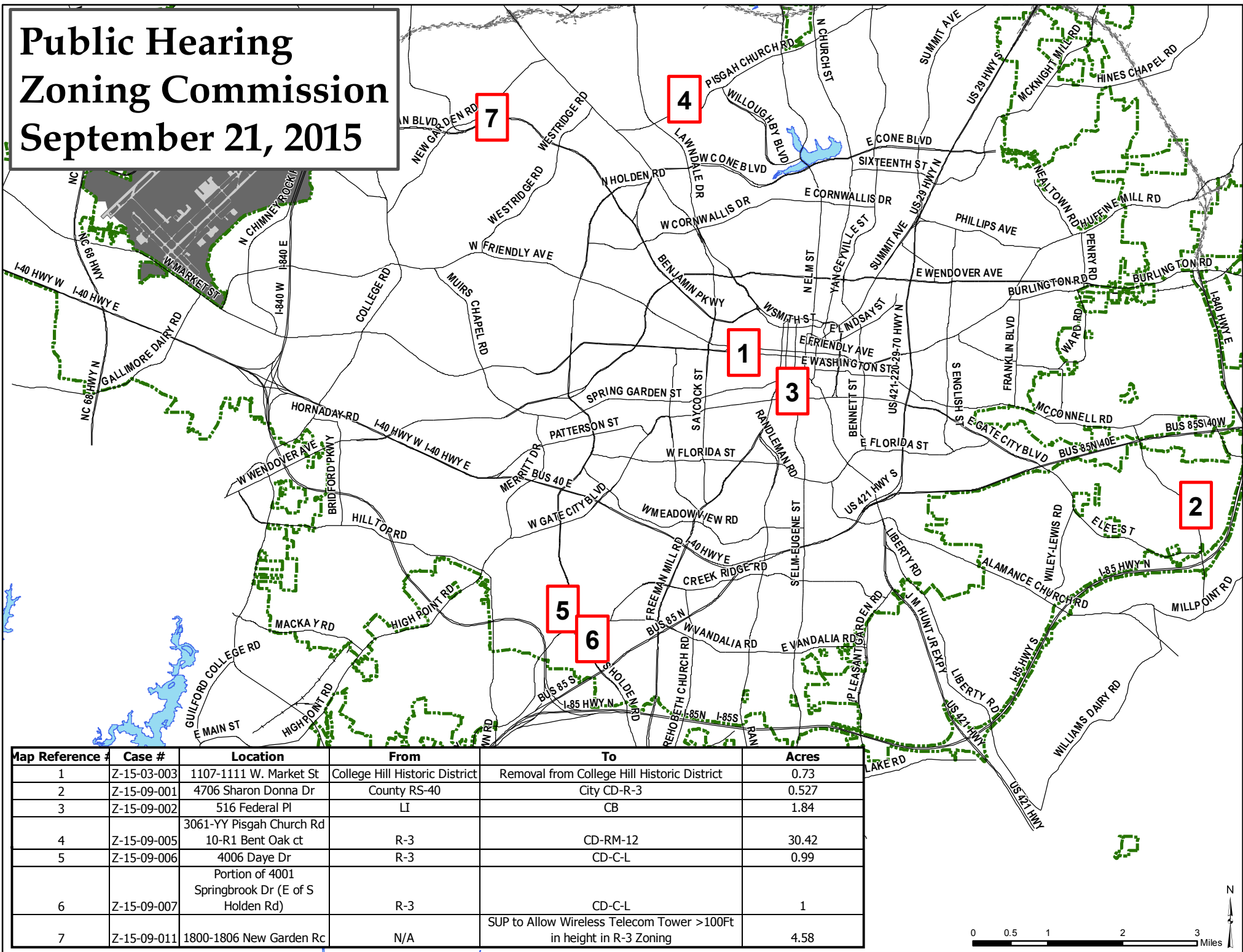

Map Reference #	Case #	Location	From	To	Acres
1	Z-15-03-003	1107-1111 W. Market St	College Hill Historic District	Removal from College Hill Historic District	0.73
2	Z-15-09-001	4706 Sharon Donna Dr	County RS-40	City CD-R-3	0.527
3	Z-15-09-002	516 Federal Pl	LI	CB	1.84
4	Z-15-09-005	3061-YY Pisgah Church Rd 10-R1 Bent Oak ct	R-3	CD-RM-12	30.42
5	Z-15-09-006	4006 Daye Dr	R-3	CD-C-L	0.99
6	Z-15-09-007	Portion of 4001 Springbrook Dr (E of S Holden Rd)	R-3	CD-C-L	1
7	Z-15-09-011	1800-1806 New Garden Rc	N/A	SUP to Allow Wireless Telecom Tower >100Ft in height in R-3 Zoning	4.58

